

CERTIFICATE OF LOCATION OF GOVERNMENT CORNER

NORTHEAST Corner of Section 28, Township 108, Range 41, 5TH P.M.

STATE OF MINNESOTA, County of MURRAY

At the corner location shown on the sketch:

On 07-08-2010 found a PK NAIL
DATE

left monument as found, lowered monument, removed monument (explain)

On 07-08-2010 placed a SURVEY MARKER WITH SEAL #43844
DATE

SKETCH OF REFERENCE TIES

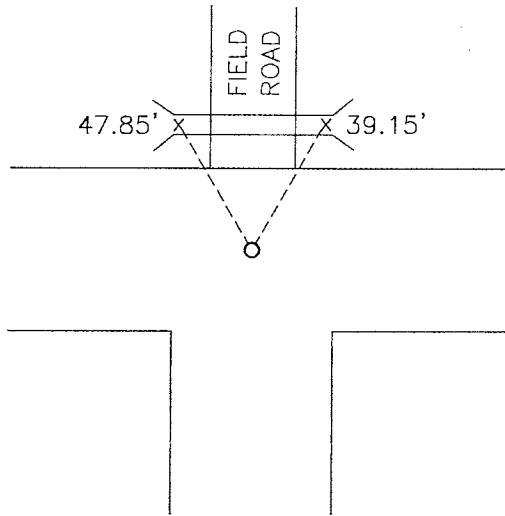

Minnesota State Plane Coordinate
System Murray County Datum
NAD83 (1996)
N: 205772.486
E: 500664.067

Chiseled "X" in R.C.P. NE 39.15'
Chiseled "X" in R.C.P. NW 47.85'

Statement of evidence relative to this corner location is on back of page.

I hereby certify that this document and the data contained herein was prepared by me or under my direct supervision.

James V. Johnson 1/12/11
SIGNATURE DATE

Registration No. 43844

Land Surveyor, Professional Engineer
 County Surveyor, County Engineer

OFFICE OF THE COUNTY RECORDER
County of _____

I hereby certify that this document was filed in the Co. Recorders office at _____ M on the _____ day of JAN 18 2011 A.D. 20 _____

County Recorder *James V. Johnson*
By _____, Deputy

DOCUMENT NO. _____

Statement of Evidence

In 1861, L.G.M. Fletcher did the original subdivision of the township.

On June 4, 1907, J. W. Woolstencroft recorded a stone at the corner.

In 1936, the Murray County Highway Department placed a concrete monument with an iron over it.

On April 7, 1970, the Murray County Highway Department found a field stone 2'± below the road surface. They set a 12" bolt above the stone.

In April, 1972, the Murray County Highway Department found a concrete monument at the corner. They set a steel pin above it.

On May 26, 1989, Duane Bonnema, #14895, found a concrete monument over a 12" bolt over a field stone with many other smaller field stones below it. He set a MNDot cast iron monument over the monuments.

On July 8, 2010, Bueltel-Moseng Land Surveying found a PK nail at the road surface. It fits the ties from the Bonnema survey. We removed the PK nail and set a survey spike with seal #43844.